

N2 Pro

Owners Manual

FCC STATEMENT :
 This device complies with Part 15 of the FCC Rules. Operation is subject to the following two conditions:
 (1) This device may not cause harmful interference, and
 (2) This device must accept any interference received, including interference that may cause undesired operation.
 Warning: Changes or modifications not expressly approved by the party responsible for compliance could void the user's authority to operate the equipment.

NOTE: This equipment has been tested and found to comply with the limits for a Class B digital device, pursuant to Part 15 of the FCC Rules. These limits are designed to provide reasonable protection against harmful interference in a residential installation. This equipment generates uses and can radiate radio frequency energy and, if not installed and used in accordance with the instructions, may cause harmful interference to radio communications. However, there is no guarantee that interference will not occur in a particular installation. If this equipment does cause harmful interference to radio or television reception, which can be determined by turning the equipment off and on, the user is encouraged to try to correct the interference by one or more of the following measures:
 Reorient or relocate the receiving antenna.
 Increase the separation between the equipment and receiver. Connect the equipment into an outlet on a circuit different from that to which the receiver is connected.
 Consult the dealer or an experienced radio/TV technician for help.

RF warning statement:
 The device has been evaluated to meet general RF exposure requirement. The device can be used in portable exposure condition without restriction.



SUDIO.COM/HELPCENTER



ศูนย์ช่วยเหลือ SUDIO
 Справочный центр Sudio
 Trung tâm trợ giúp Sudio

Sudio Help Center
 Sudio Hjälpcenter
 Sudio Hjelpesenter
 Sudio Ohjokeskus
 Sudio Hjälparmiðstöð
 Sudio Centre D'aide
 Sudio Hilfezentrum
 Sudio Helpcentrum

Sudio Centro de Ayuda
 Sudio Centro de Ajuda
 مركز مساعدة سوديو
 Sudio 도움말 센터
 Sudio 帮助中心
 Sudio 幫助中心
 Pusat Bantuan Sudio
 Sudio ヘルプセンター



EN
 Place earphones in charging case & close lid to turn off. Open the lid to turn on.

CHS
 耳机放入充电盒后关上盖子即关闭, 打开盖子即开启。

CHT
 耳機放入充電盒後關上蓋子即關閉, 打開蓋子即開啟。

JP
 電源を切る際は、充電ケースにイヤホン本体を収納し、フタを開けて下さい。イヤホンの電源はフタを開けるとすぐにオンになります。

KR
 전원을 끄 때는 충전 케이스안에 이어폰 본체를 넣은 후 뚜껑을 닫아 주세요. 이어폰의 전원은 충전 케이스의 뚜껑을 열면 바로 켜집니다.

DE
 Zum Ausschalten Ohrhörer in die Ladehülle legen & Deckel schließen. Deckel öffnen, um sie einzuschalten.

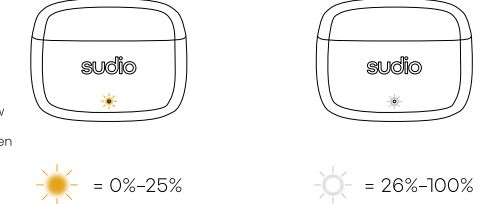

EN
 LED blinks amber light when low battery (0-25%), and white light between 26%-100%

CHS
 Led橙色灯闪烁: 电量剩余0-25%
 Led白色灯闪烁: 电量剩余26-100%

CHT
 Led橙色燈閃爍: 0-25%
 Led白色燈閃爍: 電量剩餘26-100%

JP
 バッテリー残量25%以下の場合、LEDライトがオレンジ色に点灯し、バッテリー残量26~100%の場合は白色に点灯します。

KR
 배터리 잔량 0-25%: LED 불빛이 깜빡거림
 배터리 잔량 26-100%: LED 불빛이 흰색으로 변함

DE
 LED blinkt gelb bei schwachem Akku (0-25 %) und weiß bei 26-100 %.

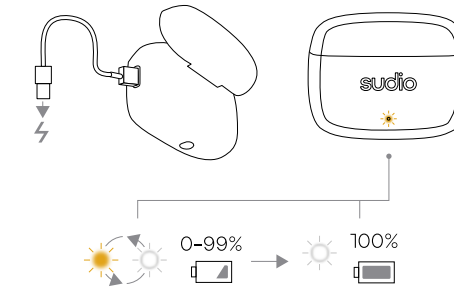

EN
 Use wireless charger or USB-C. Amber/white light = charging. White light = charged.

CHS
 可使用无线充电板或是USB-C充电线。充电时会闪橙色/白色灯, 完全充满时呈白色灯, 不会闪烁。

CHT
 可使用無線充電盤或是USB-C充電線。充電時會閃橙色/白色燈, 完全充滿時呈白色燈, 不會閃爍。

JP
 USB Type-Cケーブルまたはワイヤレス充電器を使用して下さい。充電中はLEDライトがオレンジと白色に点滅。満充電で白色に点灯します。

KR
 충전은 USB Type-C 케이블 또는 무선충전기를 사용해 주십시오. 충전 중에는 LED 불빛이 오렌지와 흰색으로, 완충 시 흰색으로 점등됩니다.

DE
 Drahtloses Ladegerät oder USB-C verwenden. Gelbes/weißes Licht = Laden. Weißes Licht = Geladen.

FR
 Utilisez chargeur sans fil/USB-C. Voyant orange = en charge. Voyant blanc = chargé.

SE
 Använd trådlös laddare eller USB-C. Orange ljus = laddar. Vitt ljus = fulladdad.

RU
 Беспроводная зарядка или USB-C. Желтый/белый свет - зарядка в процессе. Белый свет - заряжено.

ES
 Use cargador inalámbrico o USB-C. Luz ámbar/blanca = cargando. Luz blanca = cargado.

PH
 Ang LED ay nagbi-blink ng amber light kapag mahina ang baterya (0-25%), at white light sa pagitan ng 26%-100%

ID
 LED berkedip kuning saat baterai lemah (0-25%), dan lampu putih antara 26%-100%

PT
 Utilize um carregador sem fios ou USB-C. Luz âmbar/branca = a carregar. Luz branca = carregado.

