

# N2 Owners Manual

EN

Use wireless charger or USB-C. Amber/white light = charging. White light = charged.

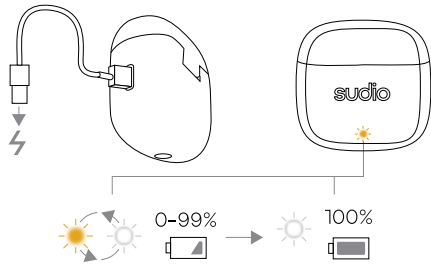

CHS

可使用无线充电板或是USB-C充电线。充电时会闪橙色/白色灯，完全充满时呈白色灯，不会闪烁。

CHT

可使用無線充電盤或是USB-C充電線。充電時會閃橙色/白色燈，完全充滿時呈白色燈，不會閃爍。

JP

USB Type-Cケーブルまたはワイヤレス充電器を使用して下さい。充電中はLEDライトがオレンジと白色に点滅、満充電で白色に点灯します。

KR

충전은 USB Type-C 케이블 또는 무선충전기를 사용해 주십시오. 충전 중에는 LED 불빛이 오렌지와 흰색으로, 완충 시 흰색으로 점등됩니다.

DE

Drhtloses Ladegerät oder USB-C verwenden. Gelbes/weißes Licht = Laden. Weißes Licht = Geladen.

FR

Utilisez chargeur sans fil/USB-C. Voyant orange = en charge. Voyant blanc = chargé.

AR

استخدم شاحن لاسلكي أو شاحن يو اسي بي. تحول اللون بين ضوء العمبر والابيض = شحن. الضوء الأبيض = مشحون.

PH

Ang LED ay nagbi-blink ng amber light kapag mahina ang baterya (0-25%), at white light sa pagitan ng 26%-100%

ID

LED berkedip kuning saat baterai lemah (0-25%), dan lampu putih antara 26%-100%

PT

Utilize um carregador sem fios ou USB-C. Luz âmbar/branca = a carregar. Luz branca = carregado.

EN

LED blinks amber light when low battery (0-25%), and white light between 26%-100%

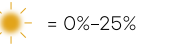

= 0%-25%

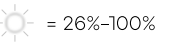

= 26%-100%

CHS

Led橙色灯闪烁: 电量剩余0-25% Led白色灯闪烁: 电量剩余26-100%

CHT

Led橙色燈閃爍: 電量剩餘0-25% Led白色燈閃爍: 電量剩餘26-100%

FR

La LED clignote orange si batterie faible (0-25 %), et blanc entre 26 % et 100 %

AR

باللون الكهرماني عند LED بومض مصباح انخفاض البطارية (0-25%). والى الضوء الأبيض بين 26%-100%

CHT

耳機放入充電盒後關上蓋子即關閉，打開蓋子即開啟。

FR

Placez les écouteurs dans le boîtier et fermez pour éteindre. Ouvrez pour allumer.

AR

ضع سماعات الأذن في علبة الشحن وأغلق الغطاء لإيقافه. افتح الغطاء للتشغيل.

JP

電源を切る際は、充電ケースにイヤホン本体を収納し、フタを開けて下さい。イヤホンの電源はフタを開けるとすぐにオンになります。

SE

Sått hörlurarna i fodralet, stäng locket för att stänga av. Öppna för att sätta på.

PH

Ilagay ang mga earphone sa charging case at isara ang takip para i-off. Buksan ang takip para i-on.

KR

전원을 끄 때는 충전 케이스안에 이어폰 본체를 넣은 후 뚜껑을 닫아 주세요. 이어폰의 전원은 충전 케이스의 뚜껑을 열면 바로 켜집니다.

RU

Поместите наушники в кейс для зарядки и закройте крышку, чтобы выключить их. Откройте крышку, чтобы включить наушники.

DE

Zum Ausschalten Ohrhörer in die Ladehülle legen & Deckel schließen. Deckel öffnen, um sie einzuschalten.

ES

Ponga los auriculares en el estuche y cierre la tapa para apagar. Abra para encender.

PT

Coloque os auriculares na caixa de carregamento e feche a tampa para ligar.

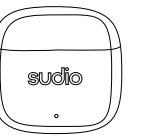

OFF



ON

Sudio Help Center	Sudio Centro de Ayuda	ศูนย์ช่วยเหลือ SUDIO
Sudio Hjälpcenter	Sudio Centro de Ajuda	Справочный центр Sudio
Sudio Hjelpesenter	مركز مساعدة سوديو	Trung tâm trợ giúp Sudio
Sudio Hjælpecenter	Sudio 도움말 센터	
Sudio Ohjokeskus	Sudio 帮助中心	
Sudio Hjälparmïstöd	Sudio 帮助中心	
Sudio Centre D'aide	Pusat Bantuan Sudio	
Sudio Hilfezentrum	Sudio ヘルプセンター	
Sudio Helpcentrum		

FCC STATEMENT :  
This device complies with Part 15 of the FCC Rules. Operation is subject to the following two conditions:  
(1) This device may not cause harmful interference, and  
(2) This device must accept any interference received, including interference that may cause undesired operation.  
Warning: Changes or modifications not expressly approved by the party responsible for compliance could void the user's authority to operate the equipment.

NOTE: This equipment has been tested and found to comply with the limits for a Class B digital device, pursuant to Part 15 of the FCC Rules. These limits are designed to provide reasonable protection against harmful interference in a residential installation. This equipment generates uses and can radiate radio frequency energy and, if not installed and used in accordance with the instructions, may cause harmful interference to radio communications. However, there is no guarantee that interference will not occur in a particular installation. If this equipment does cause harmful interference to radio or television reception, which can be determined by turning the equipment off and on, the user is encouraged to try to correct the interference by one or more of the following measures:  
Reorient or relocate the receiving antenna.  
Increase the separation between the equipment and receiver. Connect the equipment into an outlet on a circuit different from that to which the receiver is connected.  
Consult the dealer or an experienced radio/TV technician for help.

RF warning statement:  
The device has been evaluated to meet general RF exposure requirement. The device can be used in portable exposure condition without restriction.



SUDIO.COM/HELPCENTER



