

F5 Pro

Owner's Manual

Sudio Help Center
Sudio Hjalpcenter
Sudio Hjælpecenter
Sudio Hjälpcentrum
Sudio Ohjokeskus
Sudio Hjälpamidstöd
Sudio Centre D'aide
Sudio Hilfezentrum
Sudio Centro de Ayuda
Sudio Centro de Ajuda
Sudio Helpcentrum
Pusat Bantuan Sudio
ศูนย์ช่วยเหลือ SUDIO

مرکز مساعدة سوديو
Sudio 도움말 센터
Sudio 帮助中心
Sudio 幫助中心
Sudio ヘルプセンター
Справочный центр Sudio
Trung tâm trợ giúp Sudio



www.sudio.com/helpcenter

FCC STATEMENT:

This device complies with part 15 of the FCC Rules. Operation is subject to the following two conditions:

(1) This device may not cause harmful interference, and (2) this device must accept any interference received, including interference that may cause undesired operation.

Any Changes or modifications not expressly approved by the party responsible for compliance could void the user's authority to operate the equipment.

NOTE: This equipment has been tested and found to comply with the limits for a Class B digital device, pursuant to part 15 of the FCC Rules. These limits are designed to provide reasonable protection against harmful interference in a residential installation. This equipment generates uses and can radiate radio frequency energy and, if not installed and used in accordance with the instructions, may cause harmful interference to radio communications. However, there is no guarantee that interference will not occur in a particular installation. If this equipment does cause harmful interference to radio or television reception, which can be determined by turning the equipment off and on, the user is encouraged to try to correct the interference by one or more of the following measures:

- Reorient or relocate the receiving antenna.
- Increase the separation between the equipment and receiver.
- Connect the equipment into an outlet on a circuit different from that to which the receiver is connected.
- Consult the dealer or an experienced radio/TV technician for help.

The device has been evaluated to meet general RF exposure requirement. The device can be used in portable exposure condition without restriction.

Product name: Bluetooth speaker
Product model: Sudio F5 Pro

CAUTION:

- disposal of a battery into fire or a hot oven, or mechanically crushing or cutting of a battery, that can result in an explosion;
- leaving a battery in an extremely high temperature surrounding environment that can result in an explosion or the leakage of flammable liquid or gas;
- a battery subjected to extremely low air pressure that may result in an explosion or the leakage of flammable liquid or gas.

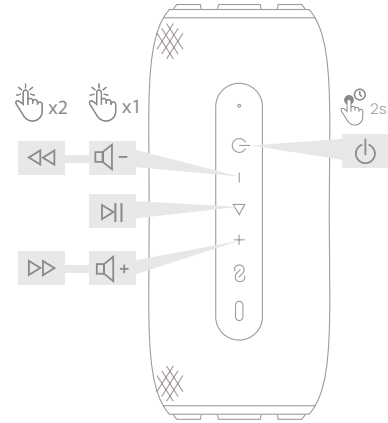
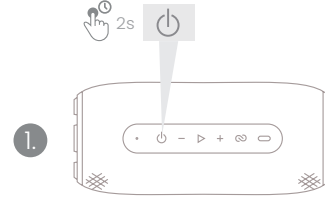
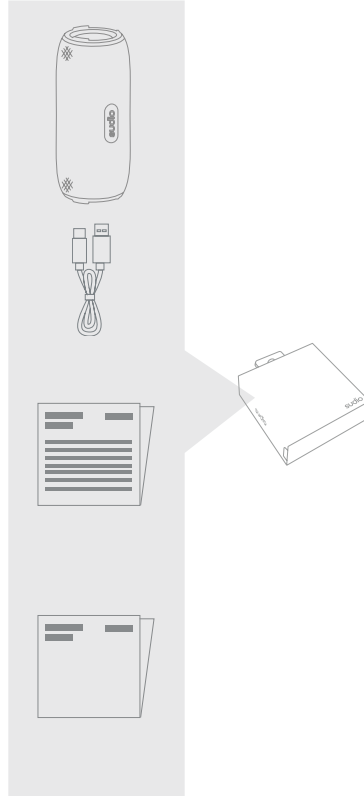

sudio

